

Lessard-Sams Outdoor Heritage Council

Fiscal Year 2021 / ML 2020 Request for Funding

HA 04



Date: May 31, 2019

Program or Project Title: Fisheries Habitat Protection on Strategic North Central Minnesota Lakes - Phase VI (2020)

Funds Requested: \$7,370,200

Manager's Name: Kathy Moore

Title: Executive Director

Organization: Northern Waters Land Trust

Address: 215 Minnesota Ave

Address 2: PO Box 124

City: Walker, MN 56484

Office Number: 218-547-4510

Email: KathyMoore@NorthernWatersLandTrust.org

Website: www.NorthernWatersLandTrust.org

County Locations: Aitkin, Cass, Crow Wing, and Hubbard.

Eco regions in which work will take place:

- Northern Forest

Activity types:

- Protect in Easement
- Protect in Fee

Priority resources addressed by activity:

- Forest
- Habitat

Abstract:

The Northern Waters Land Trust (NWLT), in partnership with the Minnesota Land Trust (MLT), will protect high priority critical fish habitat within 15 tullibee "refuge" lakes and their minor watersheds by securing conservation easements and fee title acquisitions. Through this Fisheries Habitat Protection program, NWLT and MLT are working to protect 75% of each targeted watershed, a measure that provides a high probability of maintaining clean water and healthy lake ecosystems. We will permanently protect approximately 1,266 acres and 1+ mile of shoreland through this proposal.

Design and scope of work:

Sustaining a strong angling heritage in North Central Minnesota (along with the local economy it drives) revolves largely around protecting fisheries habitat. Resurging shoreland development pressures and looming climate change are direct threats to the ecology of Minnesota's lakes. Fisheries research has shown that healthy watersheds with intact forests are fundamental to sustaining good fish habitat over the long term; achieving a 75% protection goal for a lake's watershed ensures a highly resilient and healthy lake ecosystem.

Our protection efforts are focused on tullibee (aka cisco), a preferred forage fish of walleye, northern pike, muskellunge and lake trout. They require cold, well oxygenated waters, a condition most common in lakes with deep water and healthy watersheds. Minnesota DNR Fisheries researchers studied tullibee lakes and designated 68 lakes in Minnesota as the primary "refuge lakes" for tullibee that need protection. We are targeting fifteen (15) of these lakes and their minor watershed located in Hubbard, Crow Wing, Cass, and Aitkin counties. Many are Minnesota's premier recreational lakes.

The Clean Water Critical Habitat (CWCH) Technical Committee evaluated all tullibee lakes in our project area and prioritized 16 lakes and their minor watersheds for action. In assigning priorities, the CWCH considered: (1) the ecological value of the lake, (2) the percent of the minor watershed currently protected, (3) the number of parcels in the watershed greater than 20 acres in size, (4) partner organizations available for advising on outreach efforts, and (5) investment by other agencies and organizations to protect lands and

watersheds.

Due to the high level of interest in the program and its great success to date, we are applying for a Phase VI of this effort. In this phase, we will protect 1,200 strategically important acres of land through conservation easements and fee title acquisitions. Program partners will include County Soil & Water Districts, MNDNR Fisheries, Minnesota Land Trust and NWLT. This team will conduct outreach to potential landowners and help evaluate the projects to assure we are prioritizing those projects with the greatest conservation outcomes. In addition, to ensure the best conservation return on the state's investment, landowner willingness to donate a portion of the easement value will be a key component of the parcel's evaluation. MLT will hold the easements.

We also propose securing fee-title acquisitions totaling 166 acres. This includes parcels on Wabedo Lake in Cass County, properties on Wabedo/Little Boy/Louise Lakes in Cass County (which are targeted as a part of a clustering to protect for this minor watershed), and a property on Roosevelt Lake in Cass County. The primary Wabedo Lake project is an 18-acre proposed acquisition which includes 812 ft of sensitive shoreland. This parcel adjoins county forest lands and would be conveyed to Cass County as managed forest lands. The other property on Wabedo accounts for 20 acres and 1,400 feet of shoreline. This and the Roosevelt Lake parcel (28 acres with 1,500 feet of shoreline) would be conveyed to the DNR as Aquatic Management Areas.

Which sections of the Minnesota Statewide Conservation and Preservation Plan are applicable to this project:

- H1 Protect priority land habitats
- H2 Protect critical shoreland of streams and lakes

Which other plans are addressed in this proposal:

- Long Range Plan for Fisheries Management
- Leech Lake River Comprehensive Watershed Management Plan (LLRCWMP)

Describe how your program will advance the indicators identified in the plans selected:

Protection of critical near-shore parcels, riparian areas and key forested parcels will be tracked by analyzing the land surface data of the watershed. If the tullibee "refuge" lake watershed is less than 25% disturbed by development or intensive land use and 75% of the land area of the watershed is permanently protected, these lakes can generally be assured to maintain high water quality that will support tullibee and resiliency against climate change. The LLRCWMP identifies priority lakes and watersheds which include a number tullibee refuge lake watersheds targeted within this program. A coordinated approach with LLRCWMP efforts will allow us to strategically work with area partners in achieving land protection goals within these priority watersheds. Additionally, the MN DNR AMA Plan identifies north central lakes as the priority focus for AMA's. Building on existing protected land complexes is an important criterium in prioritizing projects.

Which LSOHC section priorities are addressed in this proposal:

Northern Forest:

- Protect shoreland and restore or enhance critical habitat on wild rice lakes, shallow lakes, cold water lakes, streams and rivers, and spawning areas

Describe how your program will produce and demonstrate a significant and permanent conservation legacy and/or outcomes for fish, game, and wildlife as indicated in the LSOHC priorities:

Priority private shoreline habitat and forested parcels totaling 1100 acres will be permanently protected from development and fragmentation through conservation easements. Riparian forest lands under easement will maintain healthy habitat complexes for upland and aquatic species; forest cover will enhance water quality habitat for tullibee lakes. Greater public access for wildlife and outdoors-related recreation will be attained through fee title acquisition, with properties being open to public for hunting and fishing. Conservation easement properties will protect fish habitat to ensure high quality fishing opportunities.

Describe how the proposal uses science-based targeting that leverages or expands corridors and complexes, reduces fragmentation or protects areas identified in the MN County Biological Survey:

Timothy Cross and Peter Jacobson in their white paper, "Landscape factors influencing lake phosphorus concentrations across Minnesota" determined coldwater fish communities are especially vulnerable to eutrophication from increased phosphorus concentrations. Decreases in hypolimnetic oxygen concentrations have direct negative effects on fish such as Tullibee that physiologically require oxygenated cold water to survive, grow and reproduce. Protection is viewed as the most cost-effective strategy when applied to watersheds where human activities have not already significantly elevated phosphorus levels.

Peter Jacobson and Mike Duval, in "Protecting Watershed of Minnesota Lakes with Private Forest Conservation Easements: A Suggested Strategy", stated that protecting the forests in these watersheds from development is critical for maintaining water quality in these lakes. While large areas of land in forested portions are under public ownership, a considerable amount is also owned by private individuals in some of our most critical lake watersheds. These parcels are increasingly being "split up" and sold. Modeling by MN DNR Fisheries research unit suggests that total phosphorus concentrations remain near natural background levels when less than 25% of a lake's watershed is disturbed. Tullibee "refuge" lakes have watersheds with less than 25% disturbed land uses and are good candidates for protection. Very deep lakes with exceptional water quality to support coldwater fish populations like tullibee were considered priorities by the report.

Minnesota DNR Fisheries researchers studied tullibee lakes and designated 68 lakes in Minnesota as the primary "refuge lakes" for tullibee. We focused our protection efforts of the highest quality tullibee lakes that will require modest to moderate levels of land protection to achieve 75% protection levels. Protecting the habitats of tullibee "refuge" lakes along the shoreline and surrounding forest lands is essential to a sustained sport fishery.

How does the proposal address habitats that have significant value for wildlife species of greatest conservation need, and/or threatened or endangered species, and list targeted species:

Tullibee (aka cisco) is the preferred forage fish for walleye, northern pike, muskellunge and lake trout. They require cold, well oxygenated waters - a condition most common in lakes with deep water and healthy watersheds. Tullibee populations are the "canary in the coal mine" for three significant threats to Minnesota's sport fisheries: shoreland development, watershed health and climate warming. Deep, cold water lakes with high quality, well-oxygenated waters and natural, undisturbed land cover along the shorelines and within their watersheds will have the best chance to sustain tullibee populations in the face of these threats and will serve as a "refuge" for the tullibee if annual temperatures increase.

Minnesota DNR Fisheries research studied tullibee lakes and designated 68 lakes in Minnesota as primary "refuge lakes" for tullibee that need protection. Fifteen (15) of these lakes and their minor watersheds representing 23.5% of the designated "refuge" lakes (and minor watersheds) are located in Crow Wing, Aitkin, Cass and Hubbard counties. These lakes are premier recreational and sport fishery lakes. Fisheries research has shown that healthy watersheds with intact forest are fundamental to good fish habitat. MN DNR Fisheries Habitat Plan, states near shore fish habitat affected by shoreland disturbance can impact fisheries. Maintaining good water quality is critical to sustaining tullibeas as determined by the water's oxygen level and nutrient content. Lakeshore development decreases a lakes ability to function as a healthy ecosystem for sport fish and their forage, due to increased runoff, but also through physical alternation by lakeshore owners.

Identify indicator species and associated quantities this habitat will typically support:

The information below provides general averages for tullibee in Minnesota. These averages are generated from available data and published sources, and do not capture the variability inherent in populations of fish. Natural populations, including healthy populations with good habitat, vary among locations and rise and fall within lakes and rivers. Most fish surveys conducted by MNDNR produce an index of abundance (catch per unit effort) rather than a population estimate. MNDNR provided the following detailed information -

Aquatic system: Tullibee lakes

Indicator: Tullibee

Ave. number or biomass: NA

Other criteria: Sampling does not provide a reliable number of individuals, but assessment netting provides an indicator of tullibee presence, and the presence of multiple year classes provides evidence that tullibee are continuing to reproduce.

Outcomes:

Programs in the northern forest region:

- Increased availability and improved condition of riparian forests and other habitat corridors *Private shoreline habitat and forested parcels totaling 1,100 acres will be permanently protected from development and fragmentation through conservation easements. Riparian forest lands under easement will maintain healthy habitat complexes for upland and aquatic species; forest cover will enhance water quality habitat for tullibee lakes. Conservation easement properties will protect fish habitat to insure high quality fishing opportunities. Greater public access for wildlife and outdoors-related recreation will be attained through Fee-Title acquisition of properties to be conveyed to either Cass County as forest management lands or to the DNR as AMA's and open to public for hunting.*

How will you sustain and/or maintain this work after the Outdoor Heritage Funds are expended:

NWLT and MLT are long standing conservation organizations that do not depend on Outdoor Heritage Funds to sustain or maintain our work. The majority of financial support for both NWLT and MLT must be raised on an annual basis. The work in this proposal allows both

organizations to enhance and accelerate ongoing conservation efforts in North Central Minnesota; these grant funds will not substitute for or supplant other funding sources.

The primary fee-title acquisition will be owned and managed by either Cass County or the MN Dept of Natural Resources. The Minnesota Land Trust will hold the conservation easements acquired, which will be sustained through the best standards and practices for conservation easement stewardship. The Minnesota Land Trust is a nationally-accredited land trust with a very successful stewardship program that includes annual property monitoring, effective records management, addressing inquiries and interpretations, tracking changes in ownership, investigating potential violations and defending the easement in case of a true violation. In addition, MLT encourages landowners to undertake active ecological management of their properties, provides them with habitat management plans, and works with them over time to secure resources (expertise and funding) to undertake these activities over time.

Explain the things you will do in the future to maintain project outcomes:

Year	Source of Funds	Step 1	Step 2	Step 3
2024 and in perpetuity	MLT stewardship fund	Annually monitor easements	Enforcement as necessary	

What is the degree of timing/opportunistic urgency and why it is necessary to spend public money for this work as soon as possible:

The next ten years are a critical window of opportunity to protect some of the "best of the best" sport fishery lakes in Minnesota. While recent economic trends slowed shoreland development, realtors now report a resurgence of shoreland property sales. Growth will be driven by baby boomers and technology that allows landowners to live, work and play from the same location. With land values rising in the region now is the time to protect these tullibee "refugee" lakes and maximize the effectiveness of this fisheries habitat protection project. We are building considerable momentum with effective partnerships with The Nature Conservancy and North Central Conservation Roundtable. We believe these synergistic efforts will increase leveraging and maximize results.

Does this program include leverage in funds:

Yes

This proposal includes the following funds as leverage to our OHF request:

- Landowner donation in the amount of \$450,000 in easement value is proposed based on results obtained in previous and current OHF-funded grants.
- Landowner, lake association and county donation in the amount of \$176,000 is proposed for fee acquisitions.

Relationship to other funds:

- Not Listed

Describe the relationship of the funds:

Not Listed

Per MS 97A.056, Subd. 24, Any state agency or organization requesting a direct appropriation from the OHF must inform the LSOHC at the time of the request for funding is made, whether the request is supplanting or is a substitution for any previous funding that was not from a legacy fund and was used for the same purpose:

Funding procured by NWLT and MLT through funding from this Outdoor Heritage Fund proposal will not supplant or substitute any previous funding from a non-Legacy fund used for the same purpose.

Describe the source and amount of non-OHF money spent for this work in the past:

Not Listed

Activity Details

Requirements:

If funded, this proposal will meet all applicable criteria set forth in MS 97A.056 - **Yes**

Will county board or other local government approval be formally sought prior to acquisition, per 97A.056 subd 13(j) - **Yes**

Is the land you plan to acquire (fee title) free of any other permanent protection - **Yes**

Is the land you plan to acquire (easement) free of any other permanent protection - **Yes**

Do you anticipate federal funds as a match for this program - **No**

Land Use:

Will there be planting of corn or any crop on OHF land purchased or restored in this program - **No**

Is this land currently open for hunting and fishing - **No**

Will the land be open for hunting and fishing after completion - **Yes**

Cass County would manage one Wabedo property as managed forest lands and the other two fee title parcels would be managed by MN DNR as AMAs.

Will the eased land be open for public use - **No**

Are there currently trails or roads on any of the acquisitions on the parcel list - **Yes**

Describe the types of trails or roads and the allowable uses:

Most conservation easements are established on private lands, many of which have driveways, field roads and trails located on them. Often, the conservation easement permits the continued usage of established trails and roads so long as their use does not significantly impact the conservation values of the property. Creation of new roads/trails or expansion of existing ones is typically not allowed.

Will the trails or roads remain and uses continue to be allowed after OHF acquisition - **Yes**

How will maintenance and monitoring be accomplished:

Existing trails and roads on easement lands are identified in the project baseline report and will be monitored annually as part of the Land Trust's stewardship and enforcement protocols. Maintenance of permitted roads/trails in accordance with the terms of the easement will be the responsibility of the landowner.

Will new trails or roads be developed or improved as a result of the OHF acquisition - **No**

Accomplishment Timeline

Activity	Approximate Date Completed
Landowner outreach, consultation, technical assistance and easement preparation	ongoing through June 2023
Protect 166 acres on Wabedo and Roosevelt Lakes; convey to Cass County & MN DNR	6/30/2023
Protect 1,100 acres on targeted riparian and forested watershed parcels via conservation easements	6/30/2023

Budget Spreadsheet

Total Amount of Request: \$7,370,200

Budget and Cash Leverage

BudgetName	LSOHC Request	Anticipated Leverage	Leverage Source	Total
Personnel	\$394,000	\$0		\$394,000
Contracts	\$70,000	\$0		\$70,000
Fee Acquisition w/ PILT	\$1,760,000	\$176,000	Landowner, lake association and county	\$1,936,000
Fee Acquisition w/o PILT	\$0	\$0		\$0
Easement Acquisition	\$4,500,000	\$450,000	Landowner donation of easement value	\$4,950,000
Easement Stewardship	\$240,000	\$0		\$240,000
Travel	\$26,000	\$0		\$26,000
Professional Services	\$247,000	\$0		\$247,000
Direct Support Services	\$88,200	\$0		\$88,200
DNR Land Acquisition Costs	\$30,000	\$0		\$30,000
Capital Equipment	\$0	\$0		\$0
Other Equipment/Tools	\$5,000	\$0		\$5,000
Supplies/Materials	\$10,000	\$0		\$10,000
DNR IDP	\$0	\$0		\$0
Total	\$7,370,200	\$626,000		\$7,996,200

Personnel

Position	FTE	Over # of years	LSOHC Request	Anticipated Leverage	Leverage Source	Total
MLT Land Trust Personnel	0.00	0.00	\$214,000	\$0		\$214,000
NWLT Staff	1.50	3.00	\$180,000	\$0		\$180,000
Total	1.50	3.00	\$394,000	\$0		\$394,000

Budget and Cash Leverage by Partnership

BudgetName	Partnership	LSOHC Request	Anticipated Leverage	Leverage Source	Total
Personnel	MLT	\$214,000	\$0		\$214,000
Contracts	MLT	\$60,000	\$0		\$60,000
Fee Acquisition w/ PILT	MLT	\$0	\$0		\$0
Fee Acquisition w/o PILT	MLT	\$0	\$0		\$0
Easement Acquisition	MLT	\$4,500,000	\$450,000	Landowner donation of easement value	\$4,950,000
Easement Stewardship	MLT	\$240,000	\$0		\$240,000
Travel	MLT	\$14,000	\$0		\$14,000
Professional Services	MLT	\$187,000	\$0		\$187,000
Direct Support Services	MLT	\$43,700	\$0		\$43,700
DNR Land Acquisition Costs	MLT	\$0	\$0		\$0
Capital Equipment	MLT	\$0	\$0		\$0
Other Equipment/Tools	MLT	\$5,000	\$0		\$5,000
Supplies/Materials	MLT	\$0	\$0		\$0
DNR IDP	MLT	\$0	\$0		\$0
Total	-	\$5,263,700	\$450,000		\$5,713,700

Personnel - MLT

Position	FTE	Over # of years	LSOHC Request	Anticipated Leverage	Leverage Source	Total
MLT Land Trust Personnel	0.00	0.00	\$214,000	\$0		\$214,000
Total	0.00	0.00	\$214,000	\$0		\$214,000

BudgetName	Partnership	LSOHC Request	Anticipated Leverage	Leverage Source	Total
Personnel	NWLT	\$180,000	\$0		\$180,000
Contracts	NWLT	\$10,000	\$0		\$10,000
Fee Acquisition w/ PILT	NWLT	\$1,760,000	\$176,000	Landowner, lake association and county	\$1,936,000
Fee Acquisition w/o PILT	NWLT	\$0	\$0		\$0
Easement Acquisition	NWLT	\$0	\$0		\$0

Easement Stewardship	NWLT	\$0	\$0	\$0
Travel	NWLT	\$12,000	\$0	\$12,000
Professional Services	NWLT	\$60,000	\$0	\$60,000
Direct Support Services	NWLT	\$44,500	\$0	\$44,500
DNR Land Acquisition Costs	NWLT	\$30,000	\$0	\$30,000
Capital Equipment	NWLT	\$0	\$0	\$0
Other Equipment/Tools	NWLT	\$0	\$0	\$0
Supplies/Materials	NWLT	\$10,000	\$0	\$10,000
DNR IDP	NWLT	\$0	\$0	\$0
Total	-	\$2,106,500	\$176,000	\$2,282,500

Personnel - NWLT

Position	FTE	Over # of years	LSOHC Request	Anticipated Leverage	Leverage Source	Total
NWLT Staff	1.50	3.00	\$180,000	\$0		\$180,000
Total	1.50	3.00	\$180,000	\$0	-	\$180,000

Amount of Request: \$7,370,200
Amount of Leverage: \$626,000
Leverage as a percent of the Request: 8.49%
DSS + Personnel: \$482,200
As a % of the total request: 6.54%
Easement Stewardship: \$240,000
As a % of the Easement Acquisition: 5.33%

How did you determine which portions of the Direct Support Services of your shared support services is direct to this program:

NWLT and MLT have individual, pre-determined percentages.

MLT - In a process that was approved by the DNR on March 17, 2017, Minnesota Land Trust determined our direct support services rate to include all of the allowable direct and necessary expenditures that are not captured in other line items in the budget, which is similar to the Land Trust's proposed federal indirect rate. We will apply this DNR-approved rate only to personnel expenses to determine the total amount of direct support services.

What is included in the contracts line?

NWLT - One sole source provider contractor.

MLT - Writing of habitat management plans by vendors.

Does the amount in the travel line include equipment/vehicle rental? - Yes

Explain the amount in the travel line outside of traditional travel costs of mileage, food, and lodging:

Land Trust staff regularly rent vehicles for grant-related purposes, which is a significant cost savings over use of personal vehicles.

Describe and explain leverage source and confirmation of funds:

NWLT plans to cover any expenses not covered by this grant through general operating income. The Land Trust encourages landowners to fully or partially donate the value of conservation easements to the program; the leverage amount is a conservative estimate of value we expect to see donated by landowners.

Does this proposal have the ability to be scalable? - Yes

Tell us how this project would be scaled and how administrative costs are affected, describe the "economy of scale" and how outputs would change with reduced funding, if applicable:

Outputs would be reduced proportionately to the funding that was allocated. Calculations would ensure NWLT would secure one priority parcel in fee title acquisition and conduct effective landowner outreach. MLT's budget would enable a proportionate amount

of conservation easements.

What is the cost per easement for stewardship and explain how that amount is calculated?

The average cost per easement to fund the Minnesota Land Trust's perpetual monitoring and enforcement obligations is \$24,000. This figure is derived from MLT's detailed stewardship funding "cost analysis" which is consistent with Land Trust Accreditation standards. MLT shares periodic updates to this cost analysis with LSOHC staff.

Output Tables

Table 1a. Acres by Resource Type

Type	Wetlands	Prairies	Forest	Habitats	Total
Restore	0	0	0	0	0
Protect in Fee with State PILT Liability	0	0	0	166	166
Protect in Fee W/O State PILT Liability	0	0	0	0	0
Protect in Easement	0	0	0	1,100	1,100
Enhance	0	0	0	0	0
Total	0	0	0	1,266	1,266

Table 2. Total Requested Funding by Resource Type

Type	Wetlands	Prairies	Forest	Habitats	Total
Restore	\$0	\$0	\$0	\$0	\$0
Protect in Fee with State PILT Liability	\$0	\$0	\$1,910,400	\$0	\$1,910,400
Protect in Fee W/O State PILT Liability	\$0	\$0	\$0	\$0	\$0
Protect in Easement	\$0	\$0	\$5,459,800	\$0	\$5,459,800
Enhance	\$0	\$0	\$0	\$0	\$0
Total	\$0	\$0	\$7,370,200	\$0	\$7,370,200

Table 3. Acres within each Ecological Section

Type	Metro/Urban	Forest/Prairie	SE Forest	Prairie	Northern Forest	Total
Restore	0	0	0	0	0	0
Protect in Fee with State PILT Liability	0	0	0	0	166	166
Protect in Fee W/O State PILT Liability	0	0	0	0	0	0
Protect in Easement	0	0	0	0	1,100	1,100
Enhance	0	0	0	0	0	0
Total	0	0	0	0	1,266	1,266

Table 4. Total Requested Funding within each Ecological Section

Type	Metro/Urban	Forest/Prairie	SE Forest	Prairie	Northern Forest	Total
Restore	\$0	\$0	\$0	\$0	\$0	\$0
Protect in Fee with State PILT Liability	\$0	\$0	\$0	\$0	\$1,910,400	\$1,910,400
Protect in Fee W/O State PILT Liability	\$0	\$0	\$0	\$0	\$0	\$0
Protect in Easement	\$0	\$0	\$0	\$0	\$5,459,800	\$5,459,800
Enhance	\$0	\$0	\$0	\$0	\$0	\$0
Total	\$0	\$0	\$0	\$0	\$7,370,200	\$7,370,200

Table 5. Average Cost per Acre by Resource Type

Type	Wetlands	Prairies	Forest	Habitats
Restore	\$0	\$0	\$0	\$0
Protect in Fee with State PILT Liability	\$0	\$0	\$0	\$0
Protect in Fee W/O State PILT Liability	\$0	\$0	\$0	\$0
Protect in Easement	\$0	\$0	\$0	\$0
Enhance	\$0	\$0	\$0	\$0

Table 6. Average Cost per Acre by Ecological Section

Type	Metro/Urban	Forest/Prairie	SE Forest	Prairie	Northern Forest
Restore	\$0	\$0	\$0	\$0	\$0
Protect in Fee with State PILT Liability	\$0	\$0	\$0	\$0	\$11,508
Protect in Fee W/O State PILT Liability	\$0	\$0	\$0	\$0	\$0
Protect in Easement	\$0	\$0	\$0	\$0	\$4,963
Enhance	\$0	\$0	\$0	\$0	\$0

Automatic system calculation / not entered by managers

Target Lake/Stream/River Feet or Miles

1,000 feet

I have read and understand Section 15 of the Constitution of the State of Minnesota, Minnesota Statute 97A.056, and the Call for Funding Request. I certify I am authorized to submit this proposal and to the best of my knowledge the information provided is true and accurate.

Parcel List

Explain the process used to select, rank and prioritize the parcels:

Criteria based scoring systems provide a standardized set of data from which multiple projects can be compared relative to each other and individual projects can be compared against a baseline. Scoring systems are a set of data, not a final, complete decision making tool. Local expertise and experience, programmatic goals, timelines, available resources, capacity, and other more subjective factors might also come into play in project selection and decision making.

MLT and LLAWF accept proposals via an RFP process from targeted landowners with properties on prioritized tullibee lakes. A technical team of experts scores and ranks each project proposal and identifies priorities from those submitted.

The attached scoresheet provides an approach to criteria based scoring that considers: 1) Ecological Integrity/Viability as current status; 2) Threat/Urgency as a future scenario if protection is not afforded; and 3) Cost reflecting the overall value realized through the acquisition of a conservation easement (including a reflection of donative value). Ecological Integrity weights property size, condition, and context equally (at least as an initial starting point). The three primary factors, when taken together, provide a good estimate of long-term viability for biodiversity at the site: 1) Size of the parcel to be protected, 2) Condition of the habitat on the parcel, and 3) its Landscape context (both from a protection and ecological standpoint).

Section 1 - Restore / Enhance Parcel List

No parcels with an activity type restore or enhance.

Section 2 - Protect Parcel List

Aitkin

Name	TRDS	Acres	Est Cost	Existing Protection?	Hunting?	Fishing?
Cedar Lake/watershed	04727231	0	\$0	No		
Long Lake/watershed	04625210	0	\$0	No		
Round Lake/watershed	04923225	0	\$0	No		

Cass

Name	TRDS	Acres	Est Cost	Existing Protection?	Hunting?	Fishing?
Girl Lake/watershed	14128233	0	\$0	No		
Little Boy Lake/watershed	14028210	0	\$0	No		
Long Lake/watershed	14231233	0	\$0	No		
Roosevelt Lake	13826208	28	\$750,000	No		
Roosevelt Lake/watershed	13826208	0	\$0	No		
Wabedo Lake	14028232	118	\$760,000	No		
Wabedo Lake/watershed	14828232	0	\$0	No		
Wabedo/Little Boy Lake	14028210	20	\$250,000	No		

Crow Wing

Name	TRDS	Acres	Est Cost	Existing Protection?	Hunting?	Fishing?
Borden Lake/watershed	04428214	0	\$0	No		
Island Lake/Loon Lake watershed	13727205	0	\$0	No		
Ossawinamakee Lake/watershed	13628204	0	\$0	No		
Whitefish Lake/watershed	13728207	0	\$0	No		

Hubbard

Name	TRDS	Acres	Est Cost	Existing Protection?	Hunting?	Fishing?
Big Mantrap Lake/watershed	14233232	0	\$0	No		
Big Sand Lake/watershed	14138228	0	\$0	No		
Kabekona Lake/watershed	14332230	0	\$0	No		

Section 2a - Protect Parcel with Bldgs

No parcels with an activity type protect and has buildings.

Section 3 - Other Parcel Activity

No parcels with an other activity type.

Parcel Map

Fisheries Habitat Protection on Strategic North Central Minnesota Lakes - Phase VI (2020)

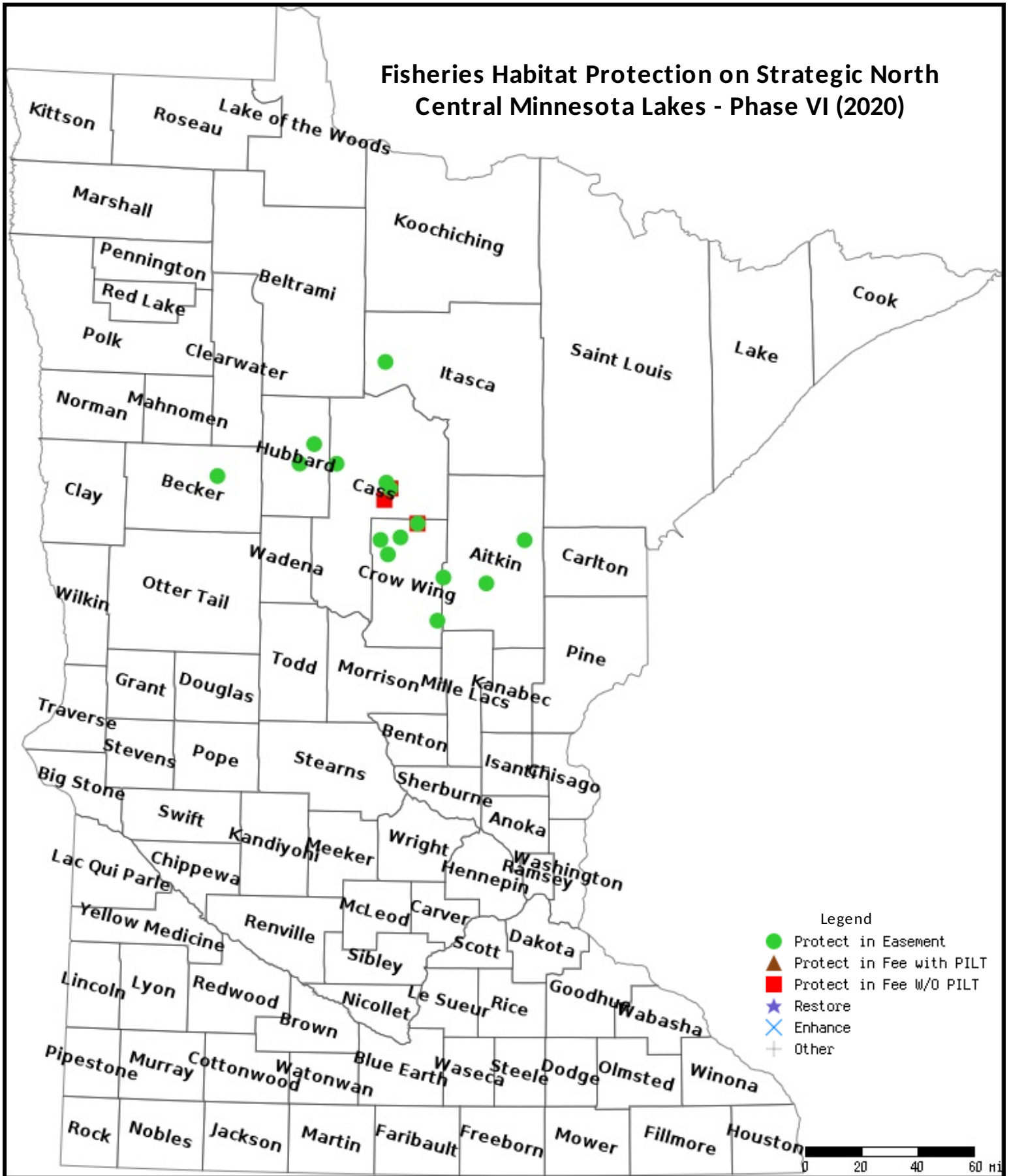

Data Generated From Parcel List



Fisheries Habitat Protection on Strategic North Central Minnesota Lakes

Phase 6

The Minnesota Land Trust and the Northern Waters Land Trust are requesting \$7,370,200 for the sixth phase of the Fisheries Habitat Protection on Strategic North Central Minnesota Lakes Program.

During the sixth phase of this program, the Minnesota Land Trust and the Northern Waters Land Trust will protect 1,266 acres (1,100 acres of permanent conservation easement and 166 acres fee-title acquisition) of high priority habitat and 3,700 ft of shoreline.

Our efforts will be focused on 15 tullibee refuge lakes and their watersheds. Applications to our easement program will be evaluated and ranked to maximize conservation benefit, leveraging \$626,000 in landowner, lake association, and supporting agency contributions.

How Does the Program Support State Goals?

This program targets critical near-shore habitats, riparian areas, and key forested parcels on 15 priority tullibee “refuge” lakes identified by Minnesota DNR Fisheries researchers. This work is in line with the goals set out in the *Long Range Plan for Fisheries Management*, and the *Long Range Plan for Muskellunge and Large Northern Pike Management Through 2020*.



Hansi Johnson

Outdoor Heritage Fund Request:

\$7,370,200 for:

- 1,100 acres of perpetual conservation easements.
- 166 acres of fee land acquisition.

For more information about this proposal, please contact Kathy Moore, Executive Director, Northern Waters Land Trust at (218)-547-4510 or KathyMoore@NorthernWatersLandTrust.org

What Are the Outcomes?

- Private forested parcels totaling 1,266 acres and more than 3,700 ft. of shoreline habitat will be protected to the benefit of tullibee.
- Forest lands will maintain healthy habitat and enhance water quality.
- Public access for wildlife and outdoors-related recreation will be attained through 166 acres of fee-title acquisition.

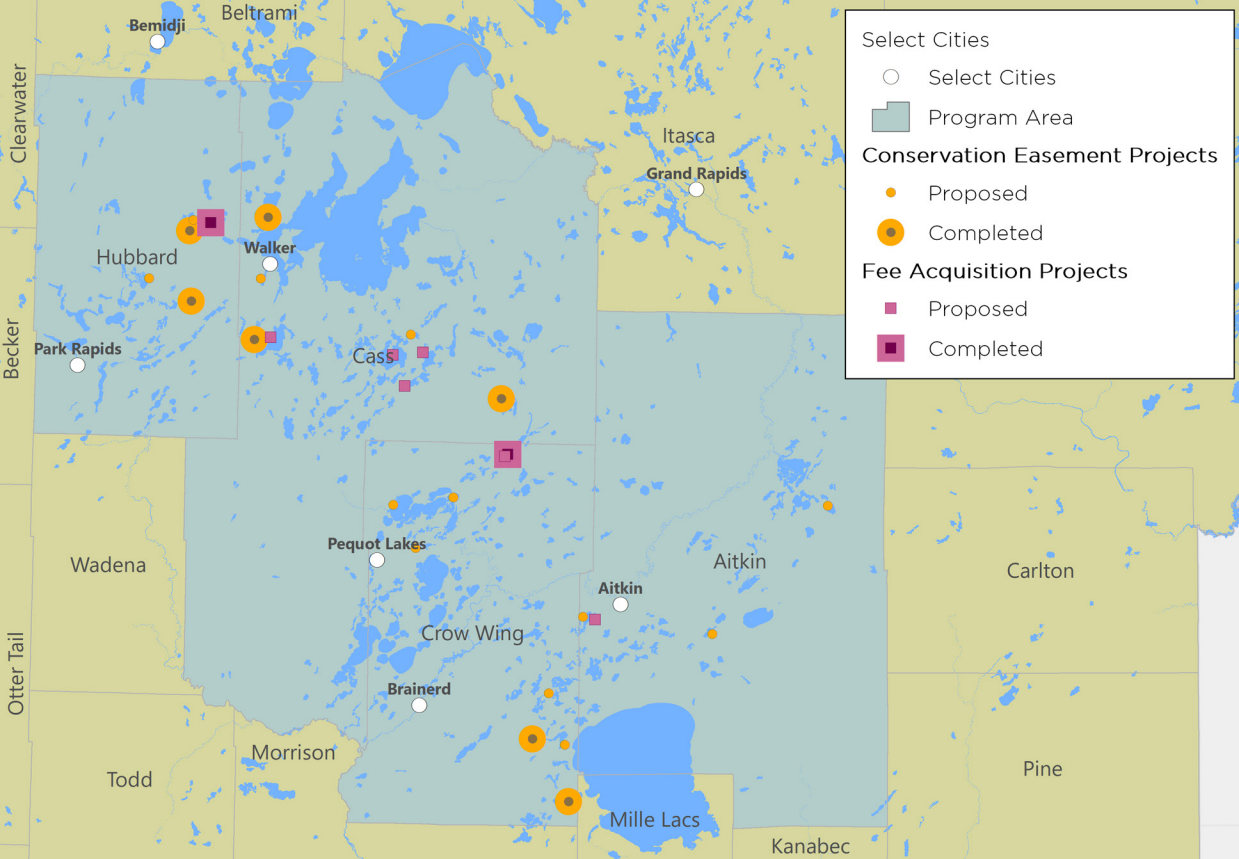

The Minnesota Land Trust protects and restores Minnesota's most vital natural lands in order to provide wildlife habitat, clean water, outdoor experiences, and scenic beauty for generations to come.

2356 University Ave. W.
Suite 240
St. Paul, MN 55114

(651) 647-9590

mnland@mnland.org

What has Been Accomplished to Date in the Program?

Complete (Phase I):

Completed 5 projects protecting 705 acres (602 acres conservation easements / 103 acres fee) of habitat and 7.9 miles of shoreline. **Leverage in the amount of \$851,000 was realized.**

In Progress (Phases II, III, and IV):

Completed 2 conservation easements protecting 477 acres of habitat and 16,541 (3.1 miles) of shoreline. We have fully subscribed our grants related to conservation easements and are on track to meet or exceed our goals. Fee title acquisition projects are on target and lands will be conveyed to the DNR for new AMAs.

Phase V (Planned):

Starting in July, we will begin using Phase V of the program to protect 520 acres and 0.5 miles of shoreline.

The Fisheries Habitat Protection on Strategic North Central Minnesota Lakes Program has generated considerable interest among landowners in protecting these places. **Collectively these landowners have contributed over \$2 million in easement value as leverage to the \$2.6 million investment from the Outdoor Heritage Fund.**



The Northern Waters Land Trust (NWLT) is a local conservation non-profit working to protect water quality and preserve land resources. Formerly the Leech Lake Area Watershed Foundation, NWLT serves the watersheds in Cass, Crow Wing, Hubbard and Aitkin Counties, representing 2,235 lakes, 3,400 miles or rivers and streams and nearly 4.2 million acres.

(218) 547-4510

info@northernwaterslandtrust.org

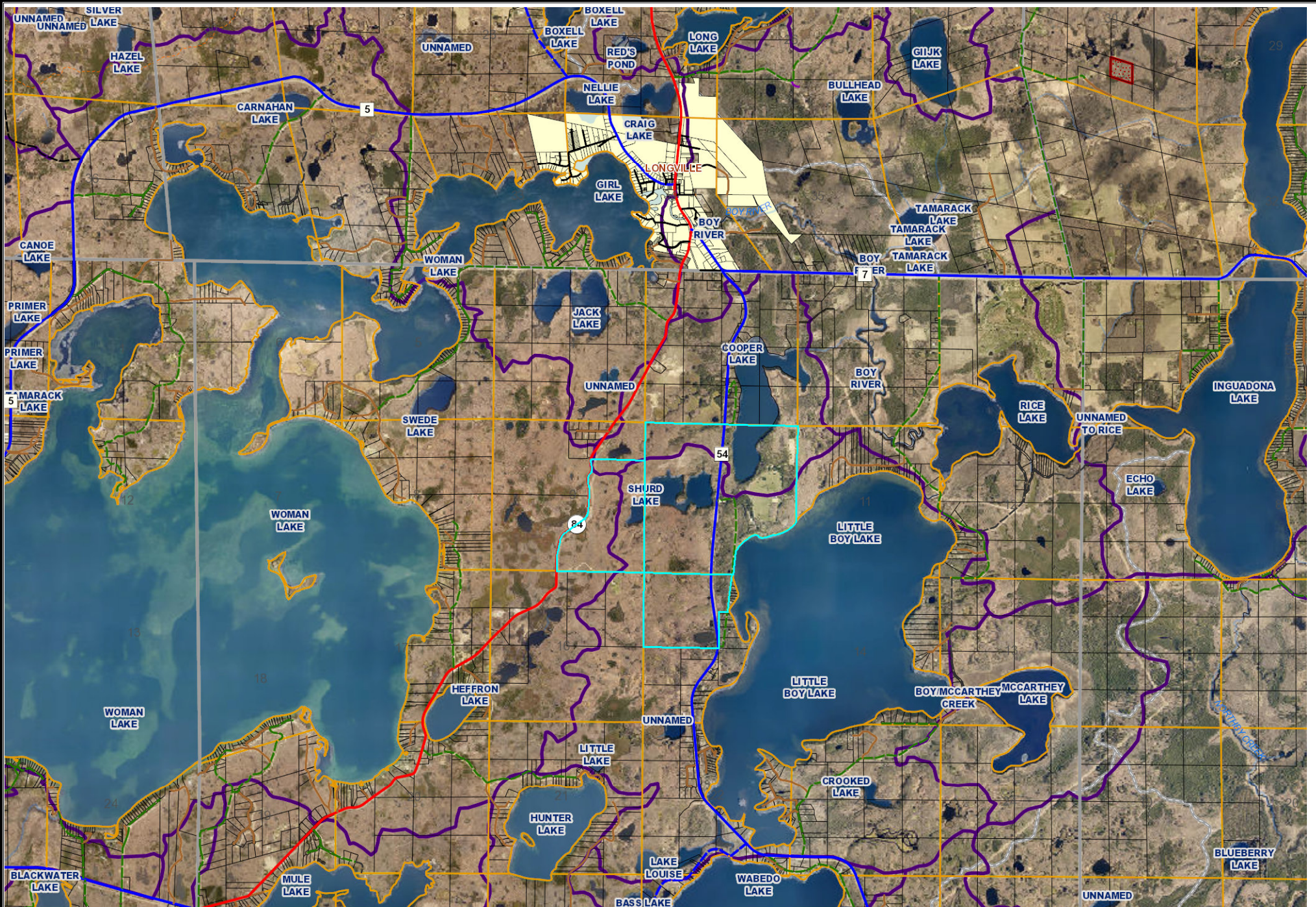

These data are provided on an "AS-IS" basis, without warranty of any type, expressed or implied, including but not limited to any warranty as to their performance, merchantability, or fitness for any particular purpose.

Camp Olson Potential Easements

Ruurd Schoolderman

This map is not a substitute for accurate field surveys or for locating actual property lines and any adjacent features.

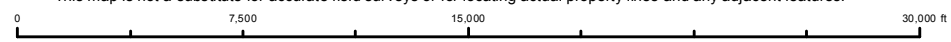

Date: 5/22/2019

Clean Water Critical Habitat Project Scoresheet

Program Requirements	
In a tullibee lake watershed?	Yes or No
In Aitkin, Cass, Crow Wing or Hubbard County?	Yes or No
At least 20 acres protected in Conservation Easement?	Yes or No
Others?	Yes or No

1. ECOLOGICAL FACTORS

Size/Abundance of Habitat (1/3 of Overall Ecological Score)

Criteria	Score	Max Points	Draft Guidelines -
Feet of Shoreline	0	30	10 points for 0 - 2,000 feet
			15 points for 2,001 - 5,000 feet
			20 points for 5,001 - 10,000 feet
			25 points for 10,001 - 20,000 feet
			30 points for ≥ 20,000 feet
Parcel Acres to be Protected by Easement	0	60	10 points for 10 - 30 acres
			20 points for 31 - 80 acres
			30 points for 81 - 160 acres
			40 points for 161 - 300 acres
			50 points for 301 - 400 acres
			60 points for ≥ 401 acres
	0	Size/Abundance Subtotal Score	

Quality/Condition of Resource (1/3 of Overall Ecological Score)

Criteria	Score	Max Points	Draft Guidelines -
Designated Sensitive Shoreland	0	30	10 point for ≤ 33%
			20 points for 34 - 66%
			30 points for 67 - 100%
% Property Developed (more development, less value)	0	30	0 points for ≥ 31% developed
			10 points for 21 - 30% developed
			20 points for 11 - 20% developed
			30 points for 0 - 10% developed
Site visit/Aerial evaluation	0	30	Quality habitat on property
			0 points - Highly impacted (trails, logging, structures etc.)
			10 points - Moderately impacted (significant number of trails, land disturbance)
			20 points - Mostly in natural state (limited natural foot trails, good forest management, no structures etc.)
			30 points - Undisturbed natural state
	0	Quality/Condition of Resource Score	

Landscape Context (1/3 of Overall Ecological Score)

Criteria	Score	Max Points	Draft Guidelines -
Adjoining protected land	0	30	All sides=30, One side=10, No=0 Public land would include tribal land.
Near, but not adjoining, protected land within 3 miles of the property	0	30	10 point for 500 - 6,000 acres
			20 points for 6,001 - 12,000 acres
			30 points for 12,001 - 18,000 acres
Wildlife Action Network	0	30	0 points for not in WAN
			10 points Low
			15 points Low-Medium
			20 points Medium
			25 points Medium High
			30 points High
	0	Landscape Context subtotal score	
	0	Ecological Total = (Size + Quality + Landscape)/3.	

2. Threat/Urgency			
Criteria	Score	Max Points	Draft Guidelines -
Urgency - Disturbance in Minor Watershed (more disturbance, higher score)	0	45	45 points for ≥ 31% developed
			30 points for 21 - 30% developed
			20 points for 11 - 20% developed
			10 points for 0 - 10% developed
Risk Classification from Water Plans (more risk, higher score)	0	45	10 = Vigilance
			20 = Protection
			30 = Risk
			45 = High Risk
	0	Threat Urgency Total	

3. Cost - Consider after initial application screening and landowner knowledge			
Criteria	Score	Max Points	Draft Guidelines -
Cost/donative value (Bang for the buck)	0	90	90 = 90 - 100% donation
			70 = 51 - 89% donation
			50 = 26 - 50% donation
			30 = 5 - 25% donation
			0 = 0 - 4% donation

Landscape Context	0
Threat/Urgency	0
Cost/Donative Value	0
TOTAL SCORE	0